

ONE WAY

Durant Avenue

ONE WAY

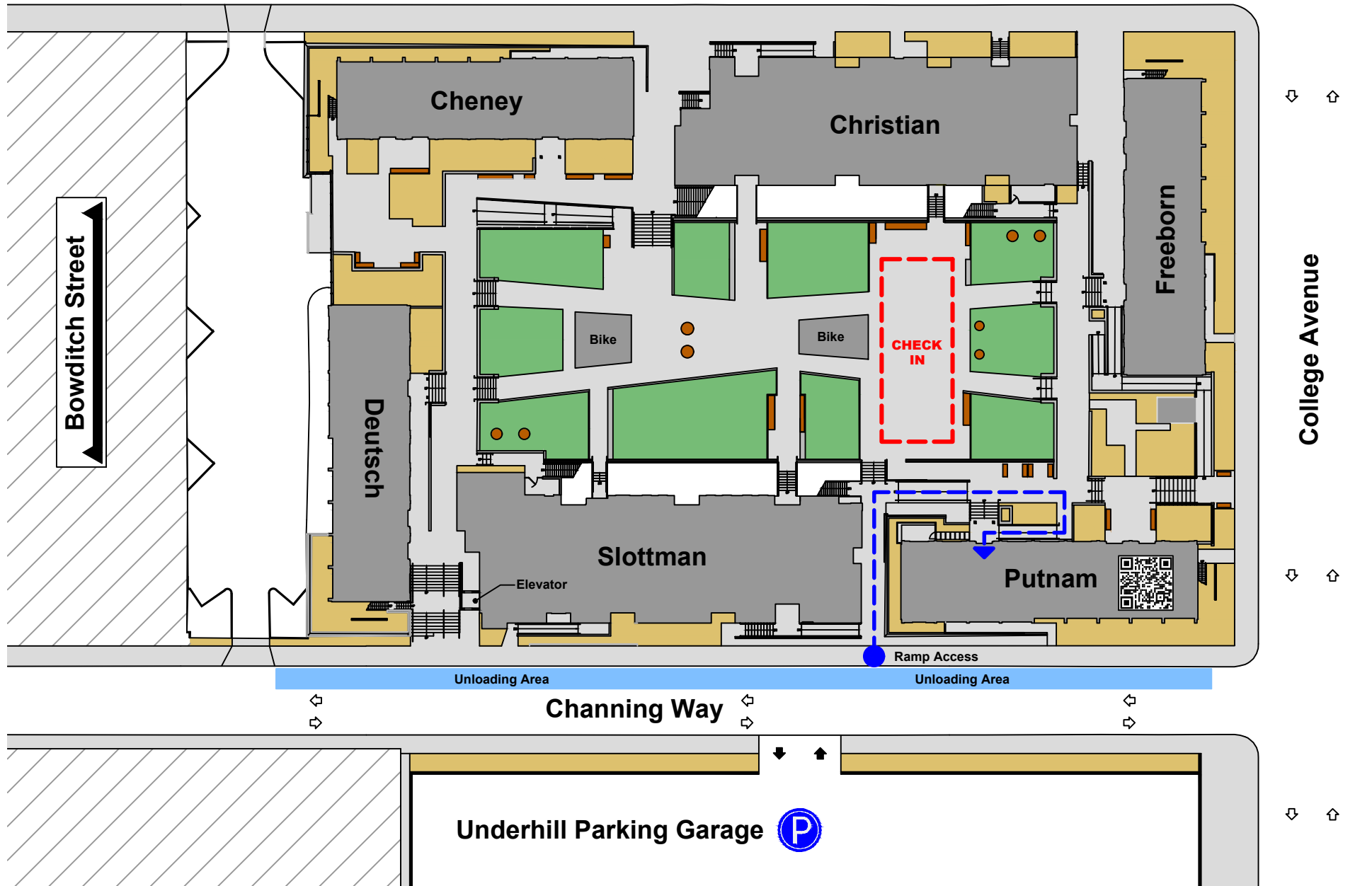

Unit 1 - Move-In Day (1/13 - 1/14)
2650 Durant Ave., Berkeley

** All buildings within this complex share the same address

- Prior to Check-in, residents must get a COVID-19 test from University Health Services at the Rec Sports Facility (RSF) Field House, 301 Bancroft Way, Berkeley, CA 94704, or the Memorial Stadium (Gate 5 area of the Field Club) 2227 Piedmont Ave, Berkeley, CA 94704.
- ➡ Advance appointments are required. <https://uhs.berkeley.edu/move-covid-19-testing-information>
- Putnam residents unload on Channing Way
- Residents check-in & carts check-out in courtyard

