



Durant Avenue



Dana Street



Telegraph Avenue

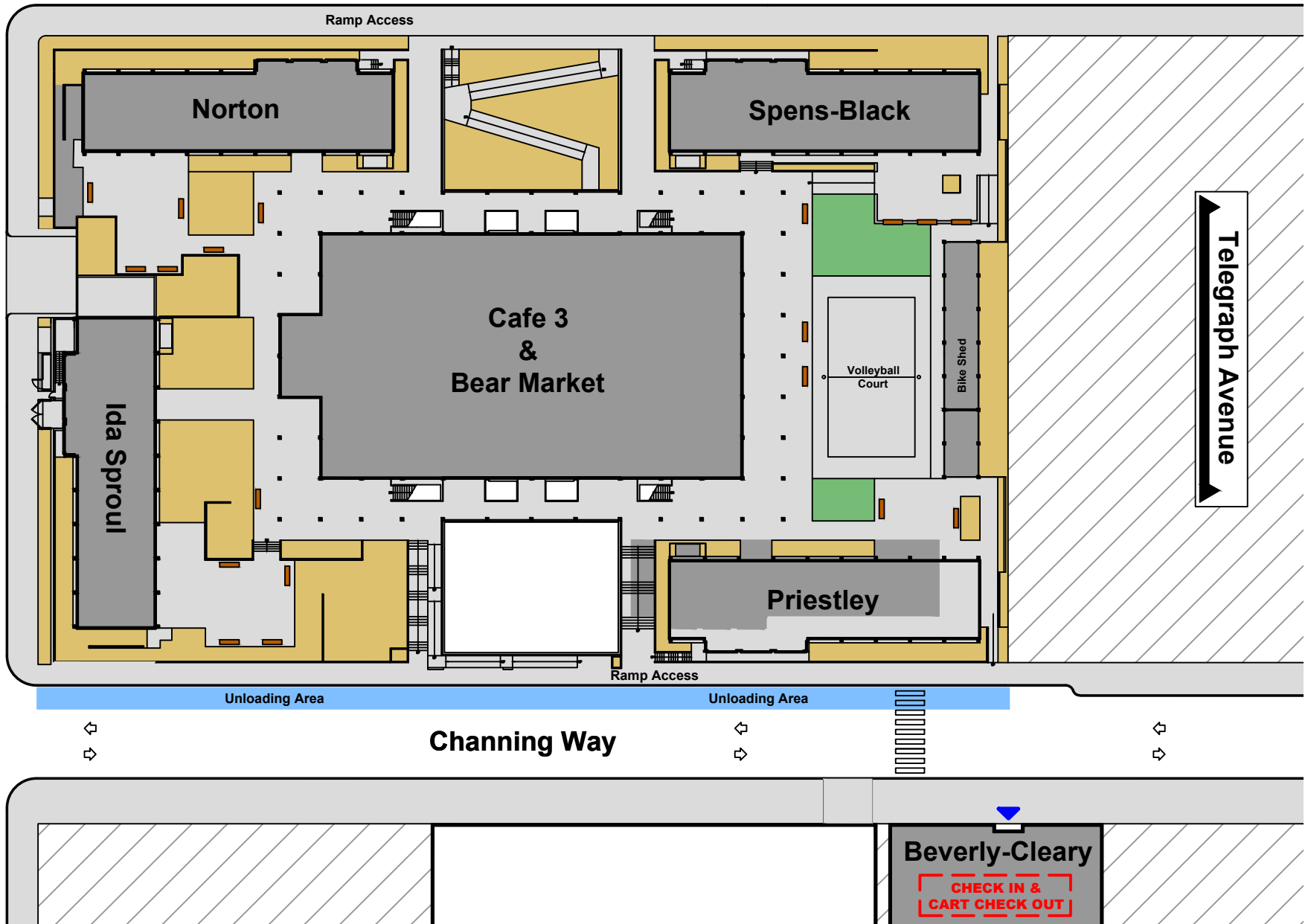

Beverly-Cleary - Move-In Day (1/14)
2424 Channing Way, Berkeley

- Prior to Check-in, residents must get a COVID-19 test from University Health Services at the Rec Sports Facility (RSF) Field House, 301 Bancroft Way, Berkeley, CA 94704, or the Memorial Stadium (Gate 5 area of the Field Club) 2227 Piedmont Ave, Berkeley, CA 94704.
- ➔ Advance appointments are required. <https://uhs.berkeley.edu/move-covid-19-testing-information>
- Beverly-Cleary residents unload on Channing Way
- Residents check-in & carts check-out in courtyard

